

FUTEK MODEL LSB350

Drawing Number: FI1073-A

INCH [mm] R.O.= Rated Output

CONNECTOR CODE (CC4)			
+Excitation	-Excitation	+Signal	-Signal
PIN 1	PIN 4	PIN 2	PIN 3

S-BEAM LOAD CELL IN TENSION AND COMPRESSION (PREVIOUSLY L2350/L2351)

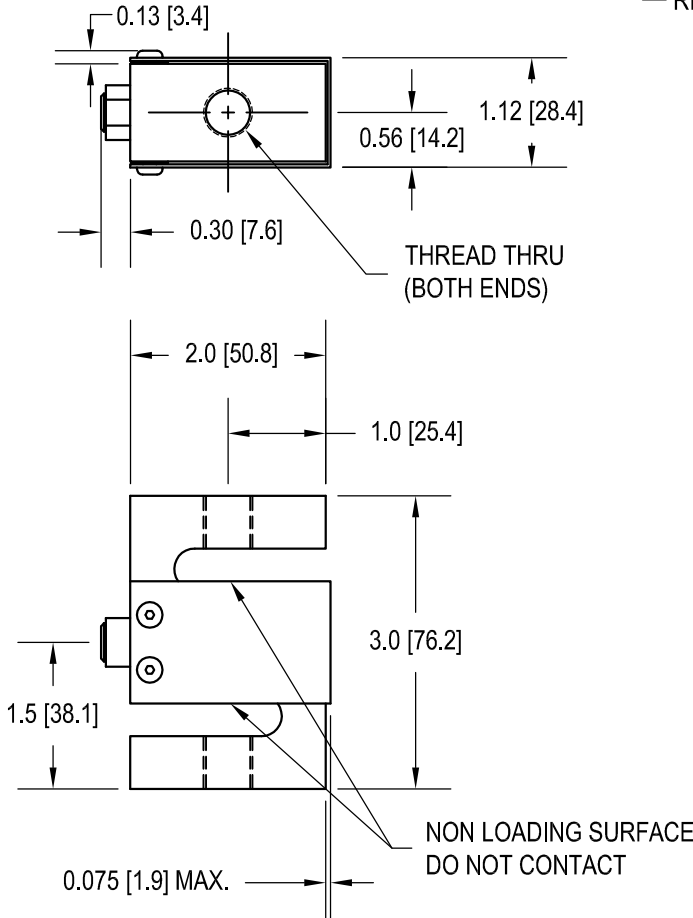
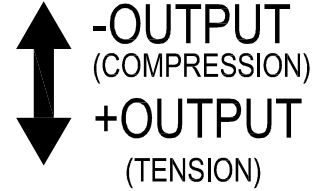
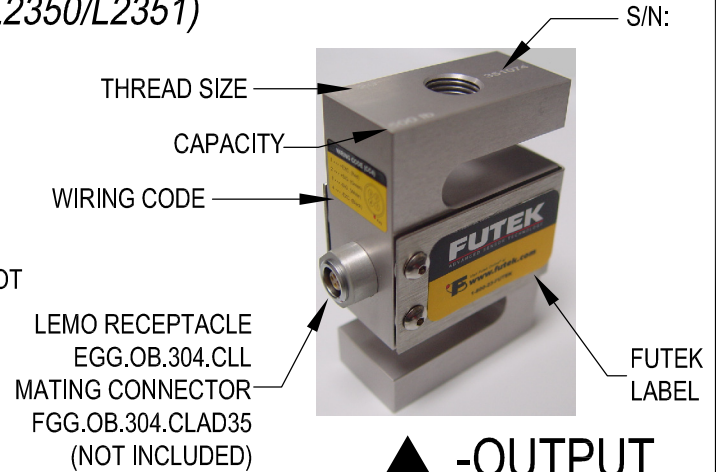
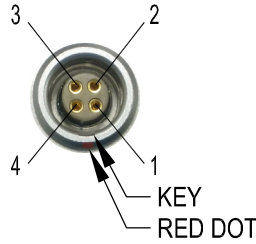

#28 AWG, 6 Conductor PU Cable (5ft) Option

WIRING CODE (WC4)			
+Excitation	-Excitation	+Signal	-Signal
RED	BLACK	GREEN	WHITE
+Sense	-Sense	Shield	
ORANGE	BLUE	Grounded	

RETRACTILE PVC CABLE AVAILABLE, CONTACT FACTORY

SPECIFICATIONS:

RATED OUTPUT	2 mV/V nom.
SAFE OVERLOAD	150% of R.O.
ZERO BALANCE	±1% of R.O.
EXCITATION (VDC OR VAC)	20 MAX
BRIDGE RESISTANCE	1000 Ω nom.
NONLINEARITY	±0.1% of R.O.
HYSTERESIS	±0.05% of R.O.
NONREPEATABILITY	±0.05% of R.O.
CREEP	±0.025% of LOAD
TEMP. SHIFT ZERO	±0.001% of R.O./°F [0.0018% of R.O./°C]
TEMP. SHIFT SPAN	±0.0008% of LOAD/°F [0.0014% of LOAD/°C]
COMPENSATED TEMP.	60 to 160°F [15 to 72°C]
OPERATING TEMP.	-60 to 200°F [-50 to 93°C]
WEIGHT	7.5 oz [212 g] (2000 lb - 18 oz [510 g])
MATERIAL	ANODIZED ALUMINUM (2000 lb - 17-4PH S.S.)
DEFLECTION	0.003 to 0.010 [0.08 to 0.25] nom.
CONNECTOR:	4 Pin LEMO Receptacle (EGG.OB.304.CLL)
ACCESSORIES AND RELATED INSTRUMENTS	
CALIBRATION (STD)	5 pt TENSION; 150K Ω SHUNT CAL. VALUE
CALIBRATION (AVAILABLE)	COMPRESSION
CALIBRATION TEST EXCITATION	10 VDC

ITEM#	CAPACITY lb	N	THREAD	CONNECTOR LEMO	CABLE
FSH00967	500	2224	1/2-20	X	
FSH02072					X
FSH00966			M12 X 1.75	X	
FSH01591					X
FSH00971	1000	4448	1/2-20	X	
FSH02070					X
FSH00970			M12 X 1.75	X	
FSH01592					X
FSH00973	2000	8896	1/2-20	X	
FSH02068					X
FSH00972			M12 X 1.75	X	
FSH01593					X